

“I wanted something special for this house, a scheme that wasn't like anything our friends had seen before”

MODERN

# Molten brown

Property developers Margaret and Edward Jones used their insider knowledge to create a warm, cream and cocoa kitchen

Margaret and Edward's kitchen is an inspired mix of dark brown and vanilla cabinetry. To stop the room looking stark, the couple have deliberately avoided using plain white. Their choice of wall colour, Perfectly Taupe by Dulux, reflects this as do the imported Spanish Efir Bronze ceramic floor tiles supplied by Saloni Cerámica





“I wouldn’t be without all the drawers and pull-out units, they are fantastic. The contents are easy to see, so I can find anything I need in a matter of seconds”

MARGARET JONES

◀ Margaret’s multifunctional Franke Mythos sink comes with a range of coordinated accessories, including a drainer basket, a drainer tray, a chopping board and a strainer bowl. These all help to make food preparation easier by keeping it in one area

◀ Dark cabinetry in the Joneses’ kitchen meant that some smart lighting solutions were needed. Extra worktop illumination is provided by downlighters held in Perspex boxes below the wall units and three fixed dazzle-free light panels along the splashback from Alno’s Niche range. The panels also provide subtle mood lighting

For more clever lighting solutions see our Focus on feature on page 130



An important aspect for the couple when designing their kitchen was to keep the workspace and dining area separate. They achieved this by adding a peninsula to act as a barrier between the two. ‘The last thing you want is to be tripping over guests when you’re cooking,’ smiles Margaret

**M**argaret and Edward Jones know exactly what makes a good kitchen after spending 30 years in the house-building industry. So when the couple were planning their own kitchen, they were in no doubt as to what sort of cabinetry they wanted. ‘We weren’t interested in anything traditional,’ Margaret explains. ‘When you’ve been in the business for as long as we have, you see the same styles going in and out of fashion. For that reason we’ve always preferred schemes that aren’t like anything our friends have seen before.’

As their three-storey property enjoys spectacular views across Glasgow, Margaret decided to site the kitchen-diner on the first floor so they could enjoy the vista. To furnish the space, the couple turned to their contacts book. ‘Tom Coughtrie had created a custom-made kitchen for us previously and we were very pleased with it,’ Margaret recalls. ‘I wanted something special for our house and knew Tom could give us exactly what we had in mind – a clearly defined kitchen layout in Alno’s gorgeous dark wood-look cabinetry. I also wanted an efficient working triangle between the hob, fridge and sink so I wouldn’t be bumping into people while I was cooking. To

achieve this I suggested placing the hob so it faced out towards the dining table so I wouldn’t have my back to guests while we were entertaining.’

A large peninsula was the ideal solution and provided a clear definition between the entertaining space and the working area that Margaret craved. Appliances have been fully integrated where possible to enhance the streamlined look the couple wanted. ‘I think that the fewer breaks there are between units, the smarter a kitchen looks,’ Margaret explains.

Guests are well-catered for in the dining area, where cabinets in Vanilla – chosen to tone in with the peninsula and the sleek granite worktops – house a coffee machine and a fridge for drinks. There’s also a large television, which is mounted onto an Alno Black-Brown oak surface to coordinate with the kitchen cabinetry and enhance the design’s sense of symmetry. These elements add to the kitchen’s impact, and make the room perfect for dinner parties or an intimate meal for two. ‘There’s no better feeling than coming down to the kitchen for breakfast, sitting at the dining table with a coffee and looking out across Glasgow,’ smiles Margaret. ‘It really sets you up for the day ahead.’



◀ Two ovens are built-in at eye level to make it easy for Margaret to monitor what’s cooking, and so that she can remove food from them without having to bend down. They are flanked on either side by a fully integrated Miele larder fridge and a freezer



▶ To encourage guests to help themselves before or after dinner, the built-in Miele coffee machine has been positioned in the dining area, next to the drinks fridge

▶ Margaret prefers to keep her pots and pans stacked in deep drawers rather than inside a cupboard as she finds it easier to lift out what she needs without crouching down



The hob and grill have been placed in the middle of the peninsula so that Margaret can socialise with her guests. The wenge dining table, leather-upholstered chairs and coordinating barstools were sourced from The Living Room



## THE KITCHEN FILE

### DESIGN & CABINETRY

- Tom Coughtrie at **Creative Designs**, Apex House, 1 Carrick Road, Ayr, Ayrshire KA7 2RA (01292 267586)
- Black-Brown oak laminate cabinetry from the AlnoPlan range with Vanilla hi-gloss units from the AlnoArt Pro range, both by Alno

### WORKTOPS

- Crème Clara Quarella. Price per linear m **£441**

### SINK & TAP

- MTG651 Mythos inset one-and-a-quarter-bowl fragranite sink in graphite, Franke **£556**
- Shannon 421 monobloc mixer tap with pull-out rinse in stainless steel, Astracast **£230**

### APPLIANCES (shown)

- H4450B built-in single oven in stainless steel, Miele **£1,300**
- H4060BM built-in combination oven in stainless steel, Miele **£1,900**
- KM390G five-burner gas hob, Miele **£875**
- KM408-2 electric gourmet grill, Miele **£562**
- DA424 island extractor, Miele **£2,400**
- CVA620-2 built-in coffee machine, Miele **£1,600**
- EGW4060-14 built-in warming drawer, Miele **£430**
- Fully integrated larder fridge, for similar try K8652, Miele **£800**
- F456i-2 fully integrated freezer, Miele **£730**

### APPLIANCES (not shown)

- Fully integrated fridge with icebox, Neff **£730**
- Fully integrated dishwasher, Miele **£802**

☎ For stockists, see page 147

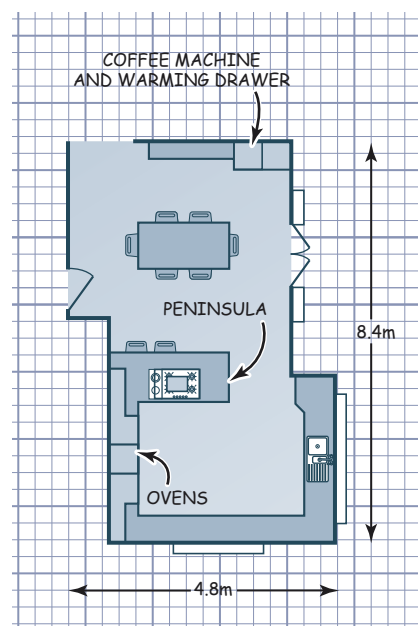

### GUIDE PRICE

- Starting price for an Alno kitchen from Creative Designs **£10,000**